

Unit: mm

## Straight Sight Glass Weld End

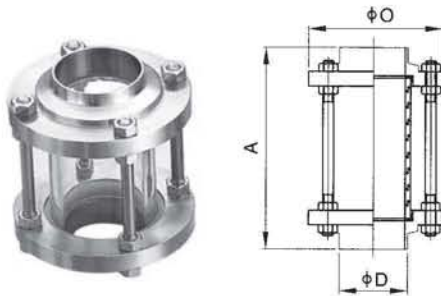

### DIN

Size	A	D	O
DN25	140.0	28.0	78.0
DN32	140.0	34.0	78.0
DN40	140.0	40.0	86.0
DN50	142.0	52.0	102.0
DN65	144.0	70.0	120.0
DN80	148.0	85.0	134.0
DN100	152.0	104.0	154.0

### SMS/ISO/IDF/3A

Size	A	D	O	
1"	25	140.0	25.4	78.0
1 1/4"	32	140.0	32.0	78.0
1 1/2"	38	140.0	38.1	86.0
2"	51	142.0	50.8	102.0
2 1/2"	63	144.0	63.5	115.0
3"	76	144.0	76.2	128.0
3 1/2"	89	148.0	89.0	139.0
4"	102	152.0	101.6	154.0

## Straight Sight Glass Thread End

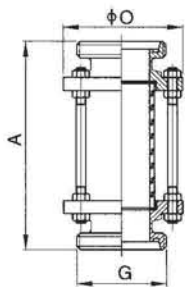

### DIN

Size	A	G	O
DN25	156.0	RD52X1/6	78.0
DN32	160.0	RD58X1/6	86.0
DN40	164.0	RD65X1/6	90.0
DN50	166.0	RD78X1/6	106.0
DN65	172.0	RD95X1/6	124.0
DN80	178.0	RD110X1/4	139.0
DN100	196.0	RD130X1/4	159.0

### SMS

Size	A	G	O
25	156.0	RD40X1/6	78.0
32	156.0	RD48X1/6	78.0
38	160.0	RD60X1/6	86.0
51	166.0	RD70X1/6	102.0
63	168.0	RD85X1/6	115.0
76	172.0	RD98X1/6	128.0
89	178.0	RD110X1/6	139.0
102	192.0	RD125X1/6	154.0

## Straight Sight Glass Clamp End

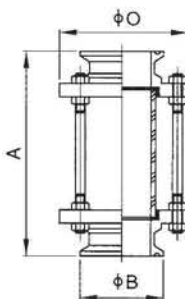

### DIN

Size	A	B	O
DN25	156.0	50.5	78.0
DN32	156.0	50.5	86.0
DN40	164.0	50.5	90.0
DN50	166.0	64.0	106.0
DN65	168.0	91.0	124.0
DN80	172.0	106.0	139.0
DN100	192.0	119.0	159.0

### SMS/ISO/IDF/3A

Size	A	B	O	
1"	25	156.0	50.5	78.0
1 1/4"	32	156.0	50.5	78.0
1 1/2"	38	160.0	50.5	86.0
2"	51	166.0	64.0	102.0
2 1/2"	63	168.0	77.5	115.0
3"	76	172.0	91.0	128.0
3 1/2"	89	178.0	106.0	139.0
4"	102	194.0	119.0	154.0

## Cross Sight Glass

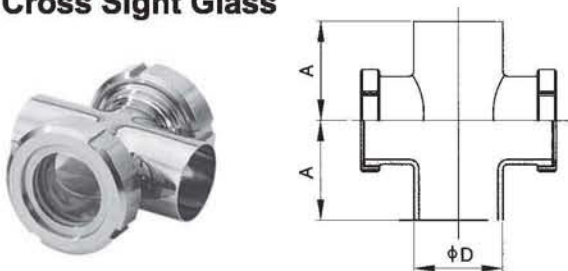

### DIN

Size	A	D
DN25	50.0	28.0
DN32	55.0	34.0
DN40	60.0	40.0
DN50	70.0	52.0
DN65	80.0	70.0
DN80	90.0	85.0
DN100	100.0	104.0

### SMS/ISO/IDF/3A

Size	A	D	
1"	25	33.5	25.4
1 1/4"	32	38.0	32.0
1 1/2"	38	48.5	38.1
2"	51	60.5	50.8
2 1/2"	63	83.5	63.5
3"	76	88.5	76.2
4"	102	127.0	101.6

## Union type Sight Glass

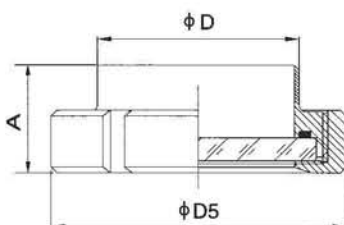

### DIN

Size	A	D	D5
DN25	35.0	28.0	63.0
DN32	38.0	34.0	70.0
DN40	40.0	40.0	78.0
DN50	42.0	52.0	92.0
DN65	47.0	70.0	110.0
DN80	52.0	85.0	125.0
DN100	62.0	104.0	146.0

### SMS

Size	A	D	D5
25	25.0	25.4	54.0
32	25.0	32.0	70.0
38	28.0	38.1	72.0
51	28.0	50.8	92.0
63	32.0	63.5	97.0
76	33.0	76.2	111.0
89	34.0	88.9	125.0
102	36.0	101.6	138.0