

Unit: mm

## Safety Valve (Relief Valve)

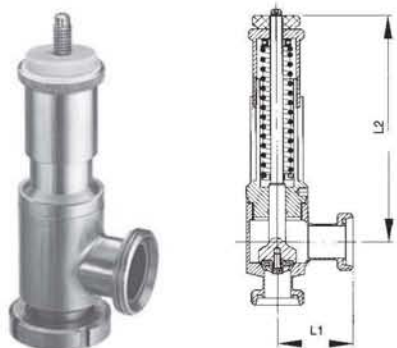

SIZE	L2	L1		
		Weld End	Thread End	Clamp End
25	210.0	60.0	40.0	60.0
32	220.0	60.0	40.0	60.0
40	230.0	70.0	50.0	70.0
50	240.0	80.0	60.0	80.0

Connection: Thread/Weld/Clamp

## Straight Strainer

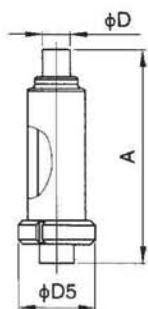

Weld End



Clamp End

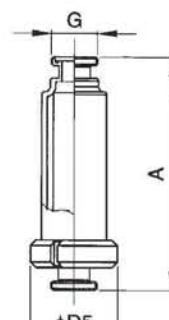

Thread End

### Weld End

SIZE			A	D5	D	
DIN	SMS	ISO/IDF/3A			DIN	SMS/ISO/IDF/3A
DN25	25	1"	306	95	28	25.4
DN32	32	1 1/4"	306	110	34	32
DN40	38	1 1/2"	306	110	40	38.1
DN50	51	2"	406	110	52	50.8
DN65	63	2 1/2"	503	127	70	63.5
DN80	76	3"	561	148	85	76.2
DN100	102	4"	662	178	104	101.6

### Clamp End

SIZE			A	D5	B
DIN	SMS	ISO/IDF/3A			
DN25	25	1"	306	95	50.5
DN32	32	1 1/4"	306	110	50.5
DN40	38	1 1/2"	306	110	50.5
DN50	51	2"	406	110	64
DN65	63	2 1/2"	503	127	77.5
DN80	76	3"	561	148	91
DN100	102	4"	662	178	119

### Thread End

SIZE				A	D5	G			
DIN	SMS	ISO/IDF/3A	RJT			DIN	SMS	ISO/IDF	RJT
DN25	25	1"	1"	306	95	RD52X1/6	RD40X1/6	37.1X8TACME	45.7X8TWHIT
DN32	32			306	110	RD58X1/6	RD48X1/6		
DN40	38	1 1/2"	1 1/2"	306	110	RD65X1/6	RD60X1/6	50.6X8TACME	58.4X8TWHIT
DN50	51	2"	2"	406	110	RD78X1/6	RD70X1/6	64.2X8TACME	72.7X6TWHIT
DN65	63	2 1/2"	2 1/2"	503	127	RD95X1/6	RD85X1/6	77.7X8TACME	85.4X6TWHIT
DN80	76	3"	3"	561	148	RD110X1/4	RD98X1/6	91.2X8TACME	98.1X6TWHIT
DN100	102	4"	4"	662	178	RD130X1/4	RD125X1/6	118.4X8TACME	123.8X6TWHIT
	102	4"	4"	662	178		RD132X1/6	125.9X6TACME	

Unit: mm

## Angle Type Strainer



Weld End

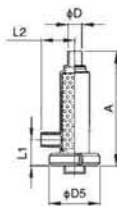

Clamp End

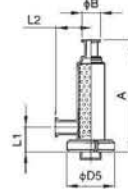

Thread End

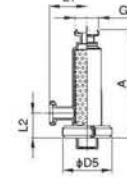

### Weld End

SIZE			A	D5	L1	L2	D	
DIN	SMS	ISO/IDF/3A					DIN	SMS/ISO/IDF/3A
DN25	25	1"	306	95	60	70	28	25.4
DN32	32	1 1/4"	306	110	60	70	34	32
DN40	38	1 1/2"	306	110	80	70	40	38.1
DN50	51	2"	406	110	100	72	52	50.8
DN65	63	2 1/2"	503	127	120	85	70	63.5
DN80	76	3"	561	148	140	96	85	76.2
DN100	102	4"	662	178	160	117	104	101.6

### Clamp End

SIZE			A	D5	L1	L2	B	
DIN	SMS	ISO/IDF/3A					DIN	SMS/ISO/IDF/3A
DN25	25	1"	306	95	60	70	50.5	50.5
DN32	32	1 1/4"	306	110	60	70	50.5	50.5
DN40	38	1 1/2"	306	110	80	70	50.5	50.5
DN50	51	2"	406	110	100	72	64	64
DN65	63	2 1/2"	503	127	120	85	91	77.5
DN80	76	3"	561	148	140	96	106	91
DN100	102	4"	662	178	160	117	119	119

### Thread End

SIZE				A	D5	L1	L2	G			
DIN	SMS	ISO/IDF/3A	RJT					DIN	SMS	ISO/IDF	RJT
DN25	25	1"	1"	306	95	60	70	RD52X1/6	RD40X1/6	37.1X8TACME	45.7X8TWHIT
DN32	32			306	110	60	70	RD58X1/6	RD48X1/6		
DN40	38	1 1/2"	1 1/2"	306	110	80	70	RD65X1/6	RD60X1/6	50.6X8TACME	58.4X8TWHIT
DN50	51	2"	2"	406	110	100	72	RD78X1/6	RD70X1/6	64.2X8TACME	72.7X6TWHIT
DN65	63	2 1/2"	2 1/2"	503	127	120	85	RD95X1/6	RD85X1/6	77.7X8TACME	85.4X6TWHIT
DN80	76	3"	3"	561	148	140	96	RD110X1/4	RD98X1/6	91.2X8TACME	98.1X6TWHIT
DN100	102	4"	4"	662	178	160	117	RD130X1/4	RD125X1/6	118.4X8TACME	123.8X6TWHIT
	102	4"		662	178	160	117		RD132X1/6	125.9X8TACME	

## Y-Type Strainer



Weld End

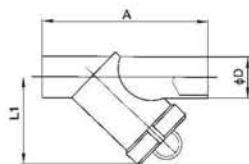

Clamp End

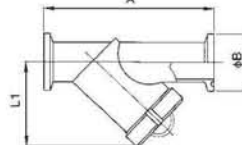

Thread End

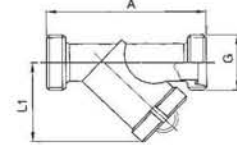

### DIN

SIZE	Weld End		Clamp End	
	A	D	L1	B
DN25	125.0	28.0	95.0	50.5
DN32	140.0	34.0	104.0	50.5
DN40	165.0	40.0	110.0	50.5
DN50	195.0	52.0	140.0	64.0
DN65	230.0	70.0	185.0	91.0
DN80	280.0	85.0	220.0	106.0
DN100	340.0	104.0	248.0	119.0

### SMS/ISO/IDF/3A

SIZE	A	Weld End		Clamp End	
		D	L1	B	
1"	25	123.0	25.4	90.0	50.5
1 1/2"	32	135.0	32.0	102.0	50.5
1 1/4"	38	144.0	38.1	107.0	50.5
2"	51	195.0	50.8	140.0	64.0
2 1/2"	63	210.0	63.5	165.0	77.5
3"	76	240.0	76.2	190.0	91.0
3 1/2"	89	295.0	89.0	225.0	106.0
4"	102	340.0	101.6	249.0	119.0

### Thread End

SIZE				G				A		L1	
DIN	SMS	ISO/IDF	RJT	DIN	SMS	ISO/IDF	RJT	DIN	SMS/ISO/IDF/RJT	DIN	SMS/ISO/IDF/RJT
DN25	25	1"	1"	RD52X1/6	RD40X1/6	37.1X8TACME	45.7X8TWHIT	125	123	95	90
DN32	32			RD58X1/6	RD48X1/6			140		104	
DN40	38	1 1/2"	1 1/2"	RD65X1/6	RD60X1/6	50.6X8TACME	58.4X8TWHIT	165	135	165	102
DN50	51	2"	2"	RD78X1/6	RD70X1/6	64.2X8TACME	72.7X6TWHIT	195	195	195	140
DN65	63	2 1/2"	2 1/2"	RD95X1/6	RD85X1/6	77.7X8TACME	85.4X6TWHIT	230	210	230	165
DN80	76	3"	3"	RD110X1/4	RD98X1/6	91.2X8TACME	98.1X6TWHIT	280	240	280	190
	89				RD110X1/6				295		225
DN100	102	4"	4"	RD130X1/4	RD125X1/6	118.4X8TACME	123.8X6TWHIT	340	340	340	249
	102	4"			RD132X1/6	125.9X6TACME			340		249