

Unit: mm

## BPE-25 90° Bend

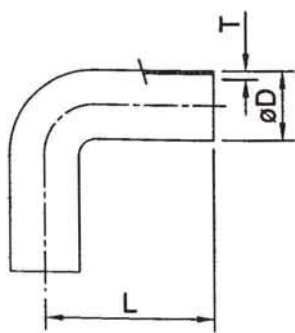

**DT-7**

SIZE	D	L	T
1/2"	12.7	76.2	1.65
3/4"	19.05	76.2	1.65
1.0"	25.4	76.2	1.65
1.5"	38.1	95.3	1.65
2.0"	50.8	120.7	1.65
2.5"	63.5	139.7	1.65
3.0"	76.2	158.8	1.65
4.0"	101.6	203.2	2.10

## BPE-2KS 45° Elbow

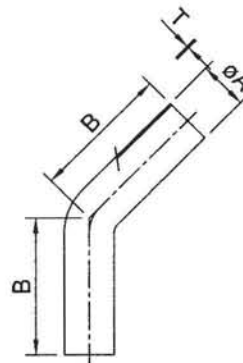

**DT-8**

SIZE	A	B	T
1/2"	12.7	57.2	1.65
3/4"	19.05	57.2	1.65
1.0"	25.4	57.2	1.65
1.5"	38.1	63.5	1.65
2.0"	50.8	76.2	1.65
2.5"	63.5	85.7	1.65
3.0"	76.2	92.1	1.65
4.0"	101.6	114.3	2.10

## BPE-7W Tee & BPE-9W Cross

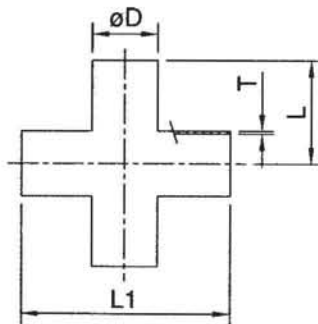
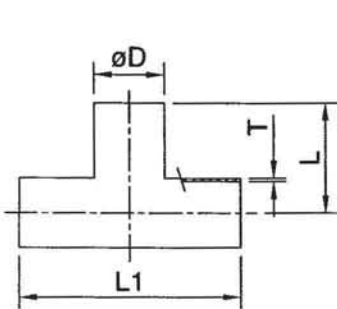

**DT-9**

SIZE	D	L	L1	T
1/2"	12.7	47.6	95.2	1.65
3/4"	19.05	50.8	101.6	1.65
1.0"	25.4	54	108	1.65
1.5"	38.1	60.3	120.6	1.65
2.0"	50.8	73	146	1.65
2.5"	63.5	79.4	158.8	1.65
3.0"	76.2	85.7	171.4	1.65
4.0"	101.6	104.8	209.6	2.10

## BPE-7RW Reducing Tee

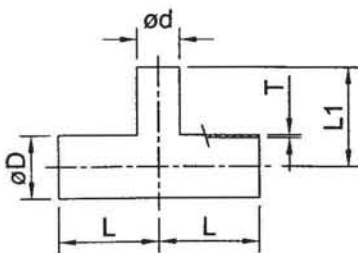

## BPE-31 Concentric & BPE-32 Eccentric Reducer

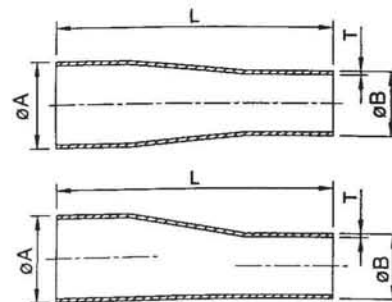

**DT-10**

SIZE	D	d	L	L1	T
3/4"x1/2"	19.05	12.7	50.8	50.8	1.65
1"x1/2"	25.4	12.7	54	54	1.65
1"x3/4"	25.4	19.05	54	54	1.65
1.5"x1/2"	38.1	12.7	60.3	60.3	1.65
1.5"x3/4"	38.1	19.05	60.3	60.3	1.65
1.5"x1.0"	38.1	25.4	60.3	60.3	1.65
2.0"x1.0"	50.8	25.4	73	66.7	1.65
2.0"x1.5"	50.8	38.1	73	66.7	1.65
2.5"x1.5"	63.5	38.1	79.4	73	1.65
2.5"x2.0"	63.5	50.8	79.4	73	1.65
3.0"x1.5"	76.2	38.1	85.7	79.4	1.65
3.0"x2.0"	76.2	50.8	85.7	79.4	1.65
3.0"x2.5"	76.2	63.5	85.7	79.4	1.65
4.0"x2.0"	101.6	50.8	104.8	98.4	2.10
4.0"x2.5"	101.6	63.5	104.8	98.4	2.10
4.0"x3.0"	101.6	76.2	104.8	98.4	2.10

**DT-11**

SIZE	A	B	L	T
3/4"x1/2"	19.05	12.7	101.6	1.65
1"x1/2"	25.4	12.7	114.3	1.65
1"x3/4"	25.4	19.05	101.6	1.65
1.5"x1/2"	38.1	12.7	139.7	1.65
1.5"x3/4"	38.1	19.05	127	1.65
1.5"x1.0"	38.1	25.4	127	1.65
2.0"x1.5"	50.8	38.1	133.4	1.65
2.5"x1.5"	63.5	38.1	184.2	1.65
2.5"x2.0"	63.5	50.8	139.7	1.65
3.0"x1.5"	76.2	38.1	235	1.65
3.0"x2.0"	76.2	50.8	190.5	1.65
3.0"x2.5"	76.2	63.5	139.7	1.65
4.0"x1.5"	101.6	38.1	342.9	2.10
4.0"x2.0"	101.6	50.8	298.5	2.10
4.0"x2.5"	101.6	63.5	247.7	2.10
4.0"x3.0"	101.6	76.2	196.9	2.10

Unit: mm

### BPE-90° Weld / Clamp Bend

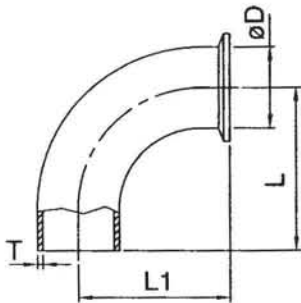

DT-12

SIZE	D	L	L1	T
1/2"	12.7	76.2	41.3	1.65
3/4"	19.05	76.2	41.3	1.65
1.0"	25.4	76.2	50.8	1.65
1.5"	38.1	95.3	69.9	1.65
2.0"	50.8	120.7	88.9	1.65
2.5"	63.5	139.7	108	1.65
3.0"	76.2	158.8	127	1.65
4.0"	101.6	203.2	168.3	2.11

### BPE-45° Weld / Clamp Bend

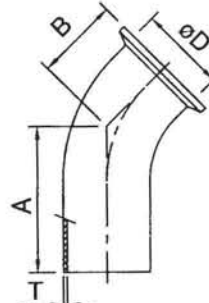

DT-13

SIZE	D	L	L1	T
1/2"	12.7	57.2	25.4	1.65
3/4"	19.05	57.2	25.4	1.65
1.0"	25.4	57.2	28.6	1.65
1.5"	38.1	63.5	36.5	1.65
2.0"	50.8	76.2	44.5	1.65
2.5"	63.5	85.7	52.4	1.65
3.0"	76.2	92.1	60.3	1.65
4.0"	101.6	114.3	79.4	2.11

### BPE-Short Outlet Weld / Clamp Reducing Tee

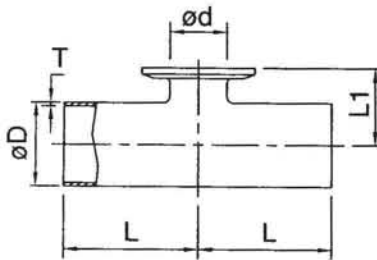

DT-14

SIZE	D	d	L	L1	T
3/4"x1/2"	19.05	12.7	50.8	25.4	1.65
1.0"x1/2"	25.4	12.7	51	28.6	1.65
1.0"x3/4"	25.4	19.05	51	28.6	1.65
1.5"x3/4"	38.1	12.7	60.3	34.9	1.65
1.5"x3/4"	38.1	19.05	60.3	34.9	1.65
1.5"x1.0"	38.1	25.4	60.3	34.9	1.65
2.0"x1/2"	50.8	12.7	73	41.3	1.65
2.0"x3/4"	50.8	19.05	73	41.3	1.65
2.0"x1.0"	50.8	25.4	73	41.3	1.65
2.0"x1.5"	50.8	38.1	73	41.3	1.65
2.5"x1/2"	63.5	12.7	79.4	47.6	1.65
2.5"x3/4"	63.5	19.05	79.4	47.6	1.65
2.5"x1.0"	63.5	25.4	79.4	47.6	1.65

SIZE	D	d	L	L1	T
2.5"x1.5"	63.5	38.1	79.4	47.6	1.65
2.5"x2.0"	63.5	50.8	79.4	47.6	1.65
3.0"x1/2"	76.2	12.7	85.7	54	1.65
3.0"x3/4"	76.2	19.05	85.7	54	1.65
3.0"x1.0"	76.2	25.4	85.7	54	1.65
3.0"x1.5"	76.2	38.1	85.7	54	1.65
3.0"x2.0"	76.2	50.8	85.7	54	1.65
3.0"x2.5"	76.2	63.5	85.7	54	1.65
4.0"x1.0"	101.6	25.4	104.8	66.7	2.11
4.0"x1.5"	101.6	38.1	104.8	66.7	2.11
4.0"x2.0"	101.6	50.8	104.8	66.7	2.11
4.0"x2.5"	101.6	63.5	104.8	66.7	2.11
4.0"x3.0"	101.6	76.2	104.8	66.7	2.11

### BPE-Equal Outlet Weld / Clamp Tee

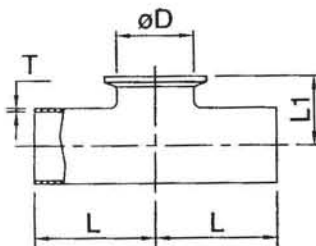

DT-15

SIZE	D	L	L1	T
1/2"	12.7	47.6	25.4	1.65
3/4"	19.05	50.8	28.6	1.65
1.0"	25.4	54	28.6	1.65
1.5"	38.1	60.3	34.9	1.65
2.0"	50.8	73	41.3	1.65
2.5"	63.5	79.4	47.6	1.65
3.0"	76.2	85.7	54	1.65
4.0"	101.6	104.8	69.9	2.11

### BPE-2CMP 90° Clamp Bend

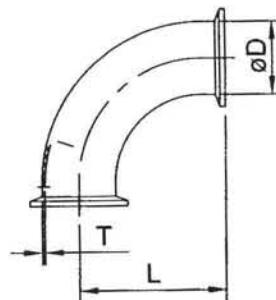

DT-16

SIZE	A	B	T
1/2"	12.7	41.3	1.65
3/4"	19.05	41.3	1.65
1.0"	25.4	50.8	1.65
1.5"	38.1	69.9	1.65
2.0"	50.8	88.9	1.65
2.5"	63.5	108	1.65
3.0"	76.2	127	1.65
4.0"	101.6	168.3	2.10

### BPE-7MP Clamp Tee & BPE-9MP Cross

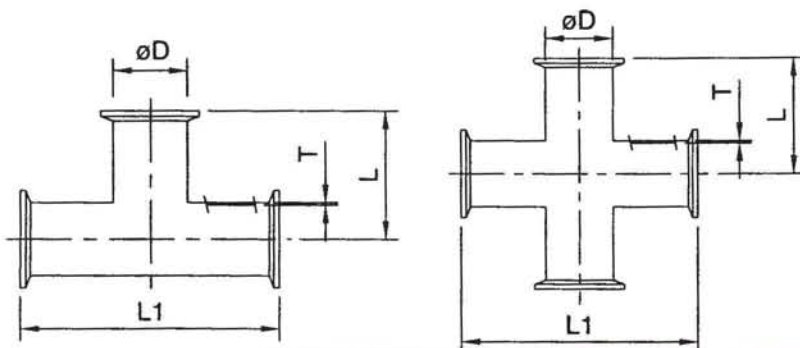

DT-18

SIZE	D	L	L1	T
1/2"	12.7	57.2	114.4	1.65
3/4"	19.05	60.3	120.6	1.65
1.0"	25.4	66.7	123.4	1.65
1.5"	38.1	73	146	1.65
2.0"	50.8	85.7	171.4	1.65
2.5"	63.5	92.1	182.2	1.65
3.0"	76.2	98.4	196.8	1.65
4.0"	101.6	120.7	241.4	2.10

Unit: mm

## BPE-2KMP 45° Clamp Elbow

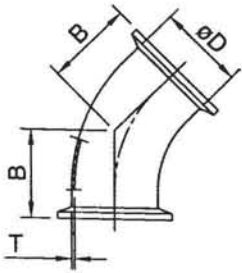

DT-17

SIZE	D	B	T
1/2"	12.7	25.4	1.65
3/4"	19.05	25.4	1.65
1.0"	25.4	28.6	1.65
1.5"	38.1	36.5	1.65
2.0"	50.8	44.5	1.65
2.5"	63.5	52.4	1.65
3.0"	76.2	60.3	1.65
4.0"	101.6	79.4	2.10

## BPE-180° Tube Weld

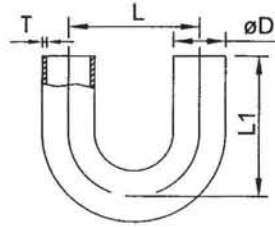

DT-23

SIZE	D	L	L1	T
1/2"	12.7	114.3	76.2	1.65
3/4"	19.05	114.3	76.2	1.65
1.0"	25.4	114.3	76.2	1.65
1.5"	38.1	152.4	114.3	1.65
2.0"	50.8	152.4	127	1.65
2.5"	63.5	190.5	146.1	1.65
3.0"	76.2	228.6	165.1	1.65
4.0"	101.6	304.8	215.9	2.11

## BPE-Reducing Tee Clamp End

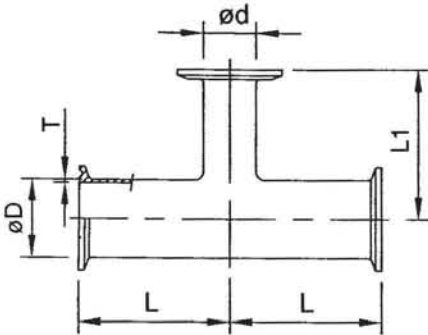

DT-19

SIZE	D	d	L	L1	T
3/4"x1/2"	19.05	12.7	63.5	63.5	1.65
1.0"x1/2"	25.4	12.7	66.7	66.7	1.65
1.0"x3/4"	25.4	19.05	66.7	66.7	1.65
1.5"x1/2"	38.1	12.7	73	73	1.65
1.5"x3/4"	38.1	19.05	73	73	1.65
1.5"x1.0"	38.1	25.4	73	73	1.65
2.0"x1.0"	50.8	25.4	85.7	79.4	1.65
2.0"x1.5"	50.8	38.1	85.7	79.4	1.65
2.5"x1.0"	63.5	25.4	92.1	85.7	1.65
2.5"x1.5"	63.5	38.1	92.1	85.7	1.65

SIZE	D	d	L	L1	T
2.5"x2.0"	63.5	50.8	92.1	85.7	1.65
3.0"x1.0"	76.2	25.4	98.4	92.1	1.65
3.0"x1.5"	76.2	38.1	98.4	92.1	1.65
3.0"x2.0"	76.2	50.8	98.4	98.4	1.65
3.0"x2.5"	76.2	63.5	98.4	98.4	1.65
4.0"x1.0"	101.6	25.4	120.7	104.8	2.11
4.0"x1.5"	101.6	38.1	120.7	104.8	2.11
4.0"x2.0"	101.6	50.8	120.7	111.1	2.11
4.0"x2.5"	101.6	63.5	120.7	111.1	2.11
4.0"x3.0"	101.6	76.2	120.7	111.1	2.11

## BPE-7RMP Clamp Reducing Tee

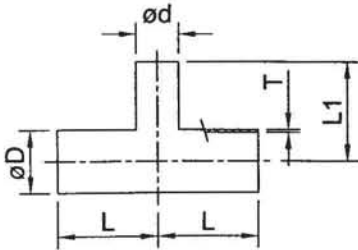

DT-20

SIZE	D	d	L	L1	T
3/4"x1/2"	19.05	12.7	63.5	25.4	1.65
1"x1/2"	25.4	12.7	66.7	28.6	1.65
1"x3/4"	25.4	19.05	66.7	28.6	1.65
1.5"x1/2"	38.1	12.7	73	34.9	1.65
1.5"x3/4"	38.1	19.05	73	34.9	1.65
1.5"x1.0"	38.1	25.4	73	34.9	1.65
2.0"x1.0"	50.8	25.4	85.7	41.3	1.65
2.0"x1.5"	50.8	38.1	92.1	47.6	1.65
2.5"x1.5"	63.5	38.1	92.1	47.6	1.65
2.5"x2.0"	63.5	50.8	92.1	47.6	1.65
3.0"x1.5"	76.2	38.1	98.4	54	1.65
3.0"x2.0"	76.2	50.8	98.4	54	1.65
3.0"x2.5"	76.2	63.5	98.4	54	1.65
4.0"x2.0"	101.6	50.8	120.7	66.7	2.10
4.0"x2.5"	101.6	63.5	120.7	66.7	2.10
4.0"x3.0"	101.6	76.2	120.7	66.7	2.10

## BPE-31-14MP Concentric & BPE-32-14MP Eccentric Reducer

DT-21

SIZE	A	B	L	T
3/4"x1/2"	19.05	12.7	50.8	1.65
1"x1/2"	25.4	12.7	63.5	1.65
1"x3/4"	25.4	19.05	50.8	1.65
1.5"x1/2"	38.1	12.7	88.9	1.65
1.5"x3/4"	38.1	19.05	76.2	1.65
1.5"x1.0"	38.1	25.4	76.2	1.65
2.0"x1.5"	50.8	38.1	76.2	1.65
2.5"x1.5"	63.5	38.1	127	1.65
2.5"x2.0"	63.5	50.8	76.2	1.65
3.0"x1.5"	76.2	38.1	177.8	1.65
3.0"x2.0"	76.2	50.8	127	1.65
3.0"x2.5"	76.2	63.5	76.2	1.65
4.0"x1.5"	101.6	38.1	282.6	2.10
4.0"x2.0"	101.6	50.8	231.8	2.10
4.0"x2.5"	101.6	63.5	181	2.10
4.0"x3.0"	101.6	76.2	130.2	2.10

Unit: mm

### BPE-180° Clamp Joint

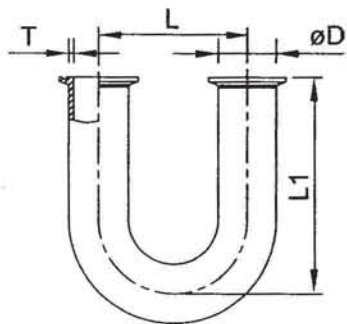

DT-24

SIZE	D	L	L1	T
1/2"	12.7	114.3	88.9	1.65
3/4"	19.05	114.3	88.9	1.65
1.0"	25.4	114.3	88.9	1.65
1.5"	38.1	152.4	127	1.65
2.0"	50.8	152.4	139.7	1.65
2.5"	63.5	190.5	165.1	1.65
3.0"	76.2	228.6	177.8	1.65
4.0"	101.6	304.8	231.8	2.11

### BPE-Short Outlet Run Tee

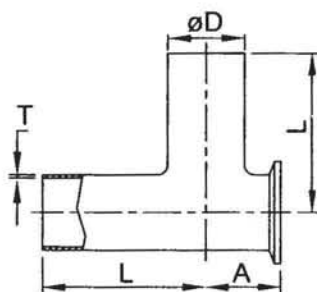

DT-25

SIZE	D	A	L	T
1/2"	12.7	22.2	47.6	1.65
3/4"	19.05	25.4	50.8	1.65
1.0"	25.4	28.6	54	1.65
1.5"	38.1	34.9	60.3	1.65
2.0"	50.8	41.3	73	1.65
2.5"	63.5	47.6	79.4	1.65
3.0"	76.2	54.0	85.7	1.65
4.0"	101.6	69.9	104.8	2.11

### BPE-Short Outlet Tee Clamp End

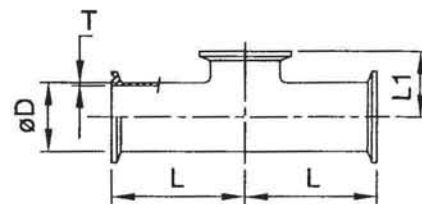

DT-26

SIZE	D	A	L	T
1/2"	12.7	57.2	25.4	1.65
3/4"	19.05	60.3	28.6	1.65
1.0"	25.4	66.7	28.6	1.65
1.5"	38.1	73	34.9	1.65
2.0"	50.8	85.7	41.3	1.65
2.5"	63.5	92.1	47.6	1.65
3.0"	76.2	98.4	54	1.65
4.0"	101.6	120.7	69.9	2.11

### BPE-Concentric & Eccentric Reducer Clamp End

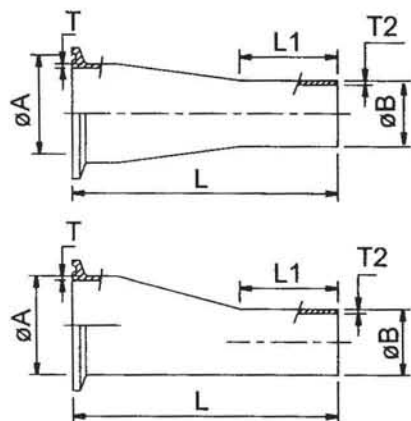

DT-26

SIZE	A	B	L	T1	T2
3/4"x1/2"	19.05	12.7	76.2	1.65	1.65
1.0"x1/2"	25.4	12.7	88.9	1.65	1.65
1.0"x3/4"	25.4	19.05	76.2	1.65	1.65
1.5"x1/2"	38.1	12.7	114.3	1.65	1.65
1.5"x3/4"	38.1	19.05	101.6	1.65	1.65
1.5"x1.0"	38.1	25.4	101.6	1.65	1.65
2.0"x1/2"	50.8	12.7	165.4	1.65	1.65
2.0"x3/4"	50.8	19.05	152.4	1.65	1.65
2.0"x1.0"	50.8	25.4	152.4	1.65	1.65
2.0"x1.5"	50.8	38.1	101.6	1.65	1.65

SIZE	A	B	L	T1	T2
2.5"x1.5"	63.5	38.1	152.4	1.65	1.65
2.5"x2.0"	63.5	50.8	108	1.65	1.65
3.0"x1.5"	76.2	38.1	203.2	1.65	1.65
3.0"x2.0"	76.2	50.8	158.8	1.65	1.65
3.0"x2.5"	76.2	63.5	108	1.65	1.65
4.0"x1.5"	101.6	38.1	308	2.11	1.65
4.0"x2.0"	101.6	50.8	263.5	2.11	1.65
4.0"x2.5"	101.6	63.5	212.7	2.11	1.65
4.0"x3.0"	101.6	76.2	161.9	2.11	1.65

### BPE-Instrument Tee Clamp / Weld End

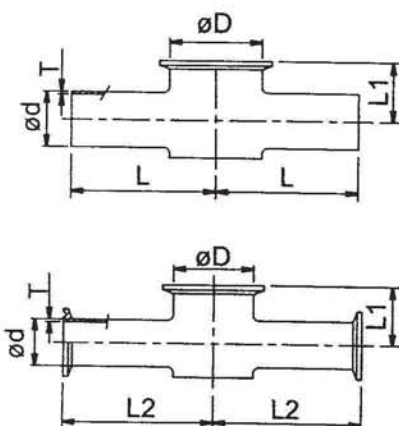

DT-28 / DT-29

SIZE	D	d	L	L1	L2	T
1.0"x1/2"	25.4	12.7	63.5	22.2	77	1.65
1.0"x3/4"	25.4	19.05	63.5	25.4	77	1.65
1.5"x1/2"	38.1	12.7	63.5	22.2	76.2	1.65
1.5"x3/4"	38.1	19.05	63.5	25.4	76.2	1.65
1.5"x1.0"	38.1	25.4	63.5	28.6	76.2	1.65
2.0"x1/2"	50.8	12.7	69.9	25.4	82.6	1.65
2.0"x3/4"	50.8	19.05	69.9	28.6	82.6	1.65
2.0"x1.0"	50.8	25.4	69.9	31.8	82.6	1.65
2.0"x1.5"	63.5	38.1	69.9	38.1	82.6	1.65
2.5"x1/2"	63.5	12.7	85	35	97	1.65
2.5"x3/4"	63.5	19.05	85	38.1	97	1.65
2.5"x1.0"	63.5	25.4	85	41.3	97	1.65
2.5"x1.5"	63.5	38.1	85	44.5	97	1.65
2.5"x2.0"	63.5	50.8	85	48	97	1.65

SIZE	D	d	L	L1	L2	T
3.0"x1/2"	76.2	12.7	90	38.1	102	1.65
3.0"x3/4"	76.2	19.05	90	41.3	102	1.65
3.0"x1.0"	76.2	25.4	90	44.5	102	1.65
3.0"x1.5"	76.2	38.1	90	48	102	1.65
3.0"x2.0"	76.2	50.8	90	50.8	102	1.65
3.0"x2.5"	76.2	63.5	90	54	102	1.65
4.0"x1/2"	101.6	12.7	110	79.4	122	1.65
4.0"x3/4"	101.6	19.05	110	82.6	122	1.65
4.0"x1.0"	101.6	25.4	110	85.7	122	1.65
4.0"x1.5"	101.6	38.1	110	88.9	122	1.65
4.0"x2.0"	101.6	50.8	110	95.2	122	1.65
4.0"x2.5"	101.6	63.5	110	98.4	122	1.65
4.0"x3.0"	101.6	76.2	110	101.6	122	1.65

Unit: mm

## BPE-14AMP-AWF Weld Ferrule

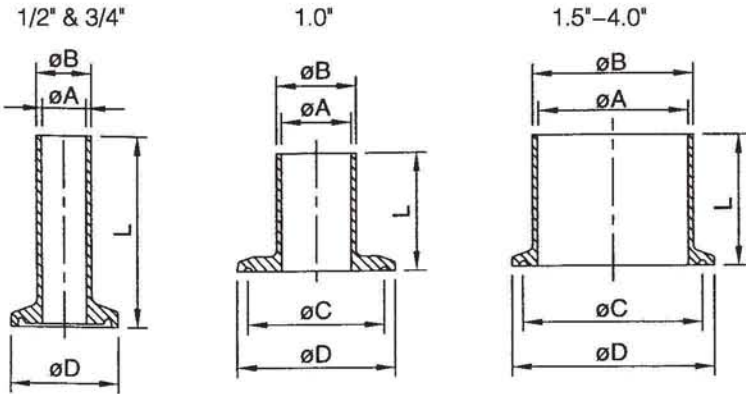

SIZE	A	B	C	D	L	L1	L2
1/2"	9.40	12.7	/	25	44.5	12.7	28.6
3/4"	15.7	19.1		25	44.5	12.7	28.6
1.0"	22.1	25.4	43.5	50.5	44.5	12.7	28.6
1.5"	34.8	38.1	43.5	50.5	44.5	12.7	28.6
2.0"	47.5	50.8	56.5	64.0	57.2	12.7	28.6
2.5"	60.2	63.5	70.5	77.5	57.2	12.7	28.6
3.0"	72.9	76.2	83.5	91.0	57.2	12.7	28.6
4.0"	97.4	101.6	110.0	119.0	57.2	12.7	28.6

## BPE-14MPHR Rubber Hose Adapter

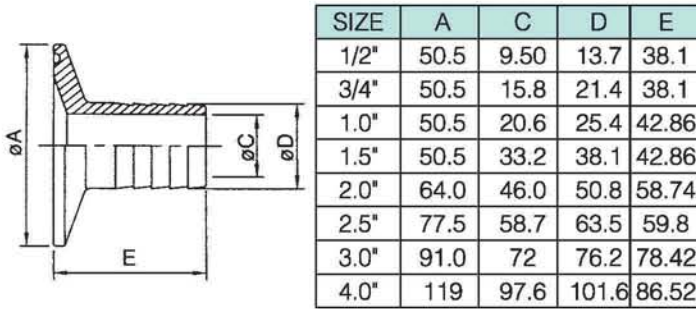

## BPE-16AMP Solid End Cap

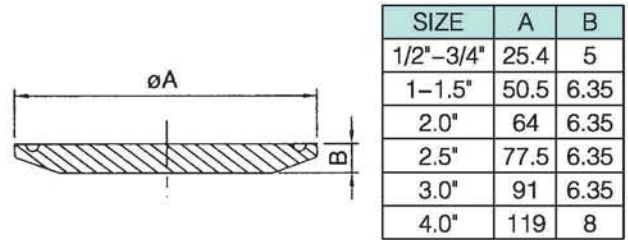

## 13MHH & 13MHHM

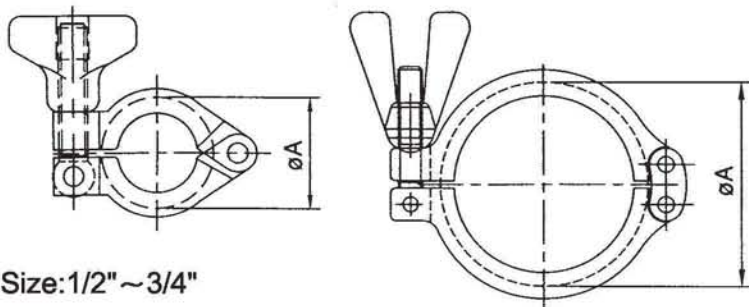

Size: 1/2" ~ 3/4"  
(13MHHM & 13MHH & 13SF)

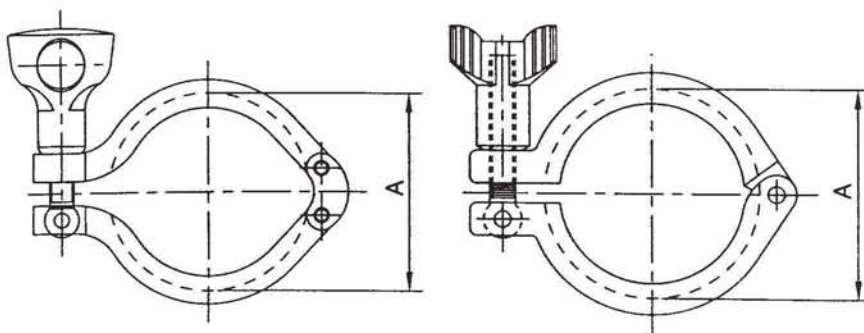

SIZE	A
1/2"-3/4"	28.2
1.5"	53.6
2.0"	67
2.5"	80.6
3.0"	94
4.0"	122
6.0"	175
8.0"	226